



PROJECT: \_\_\_\_\_  
 CATALOGUE #: \_\_\_\_\_  
 FIXTURE TYPE: \_\_\_\_\_  
 NOTES: \_\_\_\_\_

## FEATURES

### INTENDED USE

Excellent idea for your bathroom mirror or bedroom, living room, dressing table, vanity table, mirror cabinets, doorway or entryway, corridor, foyer, bar coffee shop.

### CONSTRUCTION

The modern brushed nickel base holds a frosted glass cylinder shade that will add a simple yet elegant touch to your powder room or bathroom. Can be installed with the shade facing upwards or downwards to perfectly match with any room decor, based on your preference.

### OPTICS

The vanity fixture is made of sturdy metal in brushed nickel finish which no need to worry about getting oxidation and color fading. Combined with frosted glass shades that gently diffuses light when the fixture is illuminated, add an elegant touch and different taste to your home. Update your bathroom with one easy step.

### ELECTRICAL

Easy Installation -Wall Installation, Very Easy. the Package Includes Mounting Accessories and Installation Instructions. This Vanity Light Connector is E27 or E26, Suitable for Most Light Bulbs.

### INSTALLATION

Our Vanity Lights can be mounted facing upward or downward to suit your needs. For simplicity and convenience in installation, all mounting hardware required is included in the package, you just need to connect the wire, then place the glass shade and bulb (60W max, sold separately).

### LISTINGS

ETL certified to be brighter than existing fixtures in your home.

### WARRANTY

3-year limited warranty. Complete warranty terms located at: [www.epoweron.com](http://www.epoweron.com)

### NOTE:

Actual performance may differ as a result of end-user environment and application. All values are design at typical values, measured under laboratory conditions at 25C. Specifications subject to change without notice.

# LED LAMP VANITY LIGHT MG01VL004

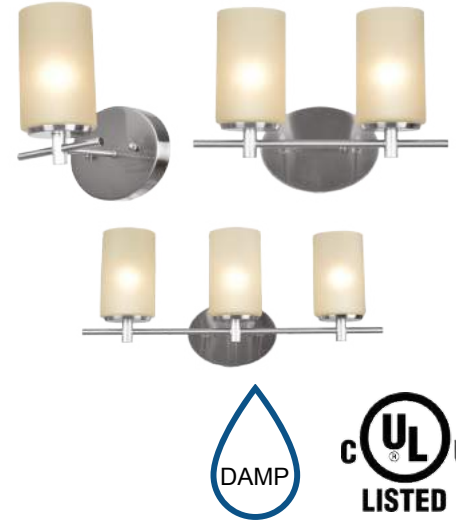

## SPECIFICATIONS

ITEM	Voltage	Watt/Socket	Body Material	Body Finish	Lens Material	Lens Finish	Base	Size	Specialty
MG01VL00400100	120 V	Max 60W	Iron	Brushed Nickel	Glass	Frosted	Medium E26	7"	Glass Cup 1 Head
MG01VL00400200	120 V	Max 60W	Iron	Brushed Nickel	Glass	Frosted	Medium E26	14"	Glass cup 2 Heads
MG01VL00400300	120 V	Max 60W	Iron	Brushed Nickel	Glass	Frosted	Medium E26	22"	Glass cu 3 Heads

## DIMENSIONS

ITEM	L	H	W
MG01VL00400100	7.09"	10"	6.57"
MG01VL00400200	14.2"	10"	6.57"
MG01VL00400300	22"	10"	6.57"

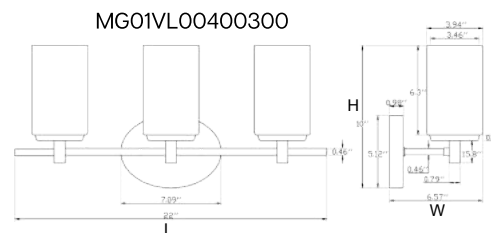

1010 Martin Luther King Jr. Pkway.  
 Suite 200  
 Durham, NC 27713  
[www.epoweron.com](http://www.epoweron.com)

Contents are subject to change without notice.

## ACCESSORIES

**P3 Wire Connector\*3**

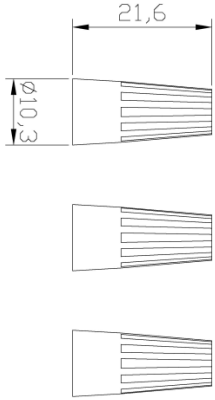

**Bracket\*1**

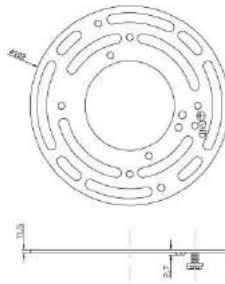

**Screw\*2**

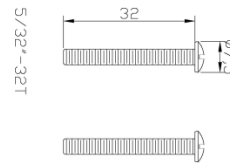

**Screw\*2**

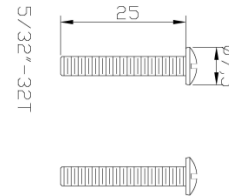

## INSTALLATION STEPS

**Step1:**Remove the plastic ring from the E26 socket, attach the glass shade and secure it with the plastic ring.

**Step2:**Drive the mounting screws into the mounting bracket and attach it to the outlet box using two outlet box screws. Connect the wires: Black to Black, White to White, Green to Green. Secure the connection with wire nuts. Carefully tuck all wires back into the outlet box.

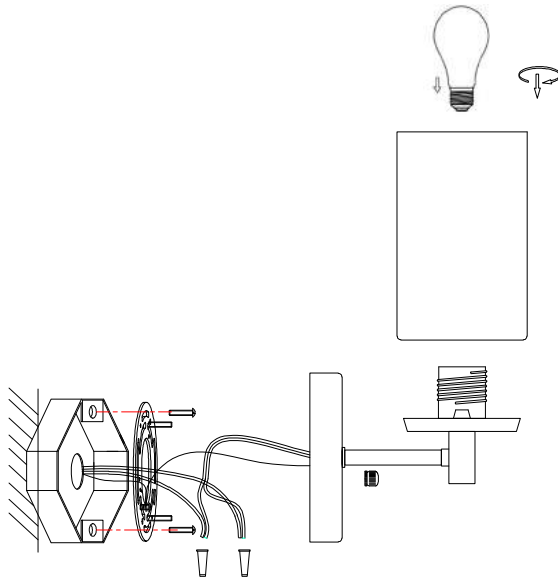

**Step3:**

Place the fixture on the wall by aligning the protruding mounting screws through the appropriate holes and tighten the fixture to the wall using two decorative nuts. Installation complete

## PACKING STRUCTURE

Model Number	Inner pack				Outer pack					Pallet(H 84")	
	Length (in)	Width (in)	Height (in)	Pieces	Width (in)	Length (in)	Height (in)	Pieces	G.W (LBS)	Cases	Pieces
MG01VL00400200	16.54	12.6	7.09	1	22.83	17.32	26.77	6	20.46	32	192
MG01VL00400300	24.02	12.6	7.09	1	24.80	22.83	26.77	2	16.06	48	96