



PROJECT: \_\_\_\_\_  
 CATALOGUE #: \_\_\_\_\_  
 FIXTURE TYPE: \_\_\_\_\_  
 NOTES: \_\_\_\_\_

## FEATURES

### INTENDED USE

Interior designers recommend hanging the pendant light in the dining room, kitchen Island, living room, bedroom, cafe, bar, club, balcony, or hallway.

### CONSTRUCTION

pendant lights are designed with hand blown white frosted glass shade and brushed nickel finish, which features classic and modern influences to blend anywhere in your home.

### OPTICS

This hanging pendant ceiling light includes all mounting hardware for quick and easy installation. E26 bulbs are recommended, but not included.

### ELECTRICAL

**MEDIUM BASE SOCKET** - The pendant features an E26 socket that is compatible with a variety of incandescent, LED, CFL and halogen bulbs (60W max, sold separately).

### INSTALLATION

**EASY TO INSTALL.** This hanging pendant ceiling light includes all mounting hardware for quick and easy installation.

### LISTINGS

ETL certified to be brighter than existing fixtures in your home.

### WARRANTY

3-year limited warranty. Complete warranty terms located at: [www.epoweron.com](http://www.epoweron.com)

### NOTE:

Actual performance may differ as a result of end-user environment and application. All values are design at typical values, measured under laboratory conditions at 25C. Specifications subject to change without notice.

# LED PENDANT LIGHT MG01PL002



## SPECIFICATIONS

ITEM	Voltage	Watt/Socket	Body Material	Body Finish	Lens Material	Lens Finish	Base	Size
MG01PL00200100	120 V	Max 60W	Iron	Brushed Nickel	Glass	Frosted	Medium E26	36"

## DIMENSIONS

ITEM	H1	H2	D1	D2
MG01PL00200100	43.21"	6.3"	4"	3.94"

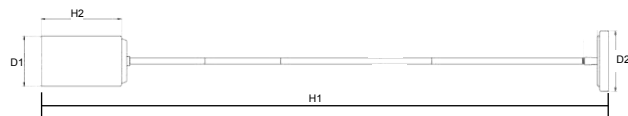

## ACCESSORIES

P3 Wire Connector\*3

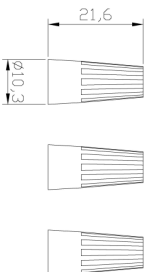

Bracket\*1

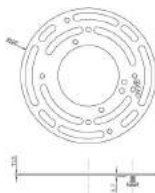

Screw\*2

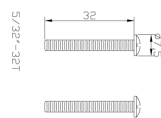

Screw\*2

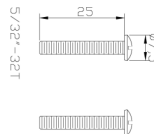

1010 Martin Luther King Jr. Pkway.  
 Suite 200  
 Durham, NC 27713  
[www.epoweron.com](http://www.epoweron.com)

Contents are subject to change without notice.

## INSTALLATION STEPS

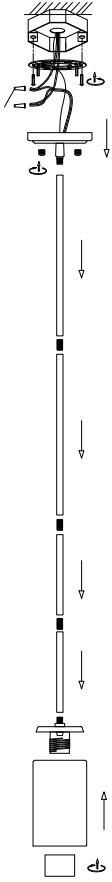

### Step1:

Remove the plastic ring from the E26 socket, attach the glass shade and secure it with the plastic ring.

### Step2:

Drive the mounting screws into the mounting bracket and attach it to the junction box using two junctionbox screws. Connect the wires: Black to Black, White to White, Green to Green. Secure the connection with wire nuts. Carefully tuck all wires back into the junction box.

### Step3:

Place the fixture on the wall by aligning the protruding mounting screws through the appropriate holes and tighten the fixture to the wall using two decorative nuts. Installation complete

## PACKING STRUCTURE

Model Number	Inner pack				Outer pack					Pallet(H 84")	
	Length (in)	Width (in)	Height (in)	Pieces	Width (in)	Length (in)	Height (in)	Pieces	G.W (LBS)	Cases	Pieces
MG01PL00200100	14.17	6.69	8.27	1	21.65	14.96	18.11	6	18.29	24	144

## UPC CODES

Product Code	Product Description	Box UPC Code	Case UPC Code
MG01PL00200100	MG LAMP PENDANT 60WMAX BRUSHED NICKEL FROSTED GLASS STRAIGHT CUP 1 E26 BASE 1PK	822985532150	10822985532157
MG01PL00200101	MG LAMP PENDANT 60WMAX BRUSHED NICKEL FROSTED GLASS STRAIGHT CUP 1 E26 BASE 1PK	822985532815	10822985532812